

ASSEMBLY INSTRUCTIONS

MODEL : WM1585-BS3

IMPORTANT NOTE :

- * PLACE ALL WOODEN PARTS ON A CLEAN AND SMOOTH SURFACE SUCH AS A RUG OR CARPET TO AVOID THE PARTS FROM BEING SCRATCHED.
- * BEFORE YOU BEGIN, KINDLY FOLLOW THE ASSEMBLY INSTRUCTIONS STEP BY STEP.
- * DO NOT TIGHTEN ALL SCREWS UNTIL THE CHAIR IS FULLY SET-UP.

HARDWARE LIST			PART LIST		
A	JCBC M6 x 45mm + S/W M6 + F/W M6 x 13mm	4PCS	1	LEG L/R	2PCS
B	ALLEN KEY M4	1PC	2	TOP STRETCHER	2PCS
C	L-BRACKET	4PCS	3	BOTTOM STRETCHER	2PCS
D	WOOD DOWEL M8 X 25mm	2PCS	4	CUSHION SEAT	1PC
E	CSK SCREW M3.5 x 12mm	8PCS			
F	FH SCREW #8 x 32mm	4PCS			

CAUTIONS :

(1) DO NOT FULLY-TIGHTEN THE NUT OR NUT BOLTS INITIALLY UNTIL ALL NUTS OR BOLT IS READY ASSEMBLED.

(TO AVOID CAUSING DAMAGES TO THE THREAD, DO NOT OVER-TIGHTEN THE NUTS OR BOLTS.)

(2) KEEP ALL HARDWARE PART OUT OF REACH OF CHILDREN.

STEP 1

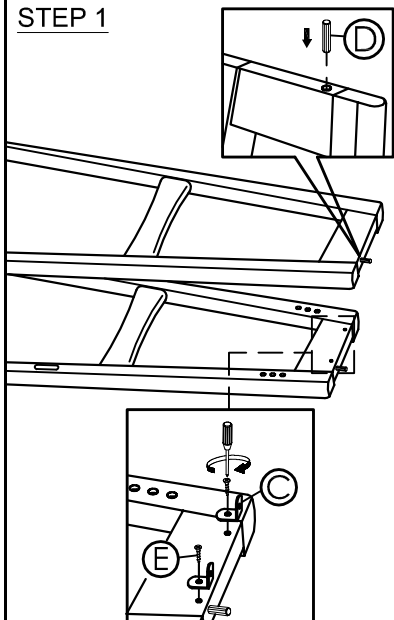

STEP 2

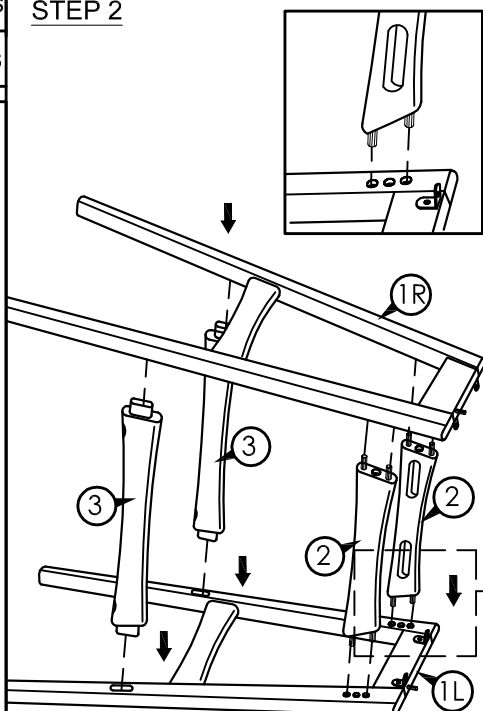

STEP 3

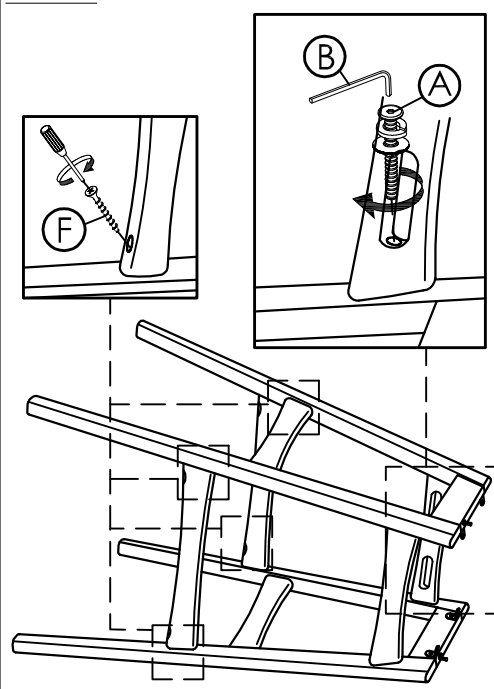

STEP 4

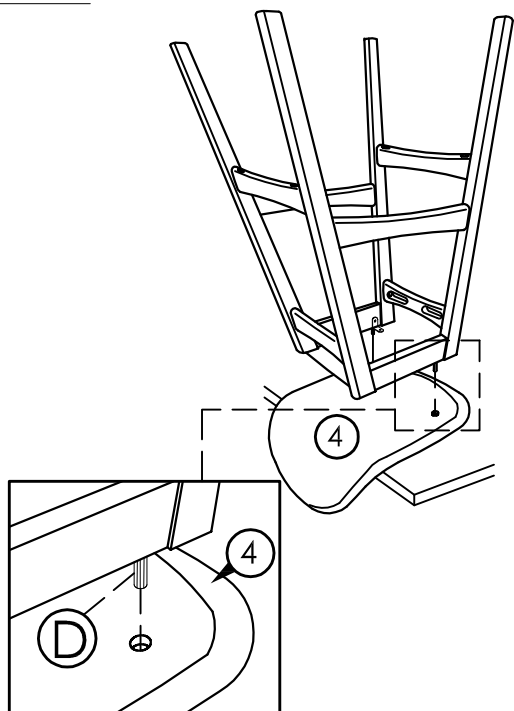

STEP 5

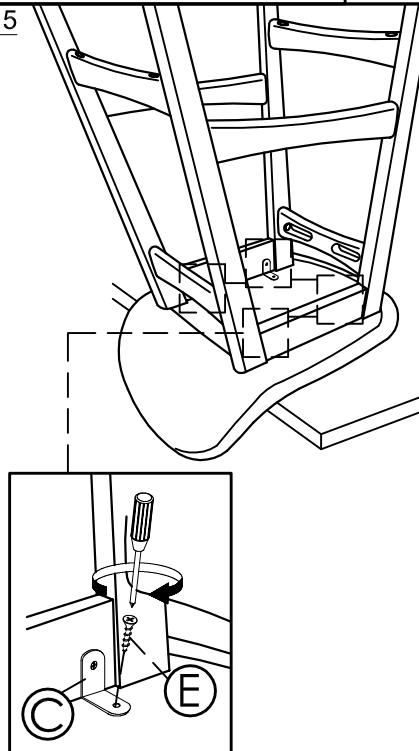

STEP 6

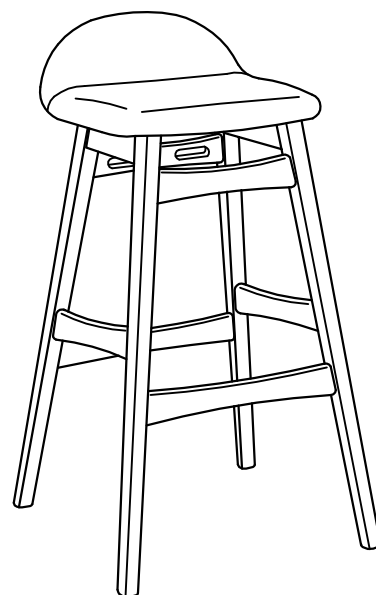

COMPLETED
CHAIR ASSEMBLY.