

Assembly instruction - Double bed Spina

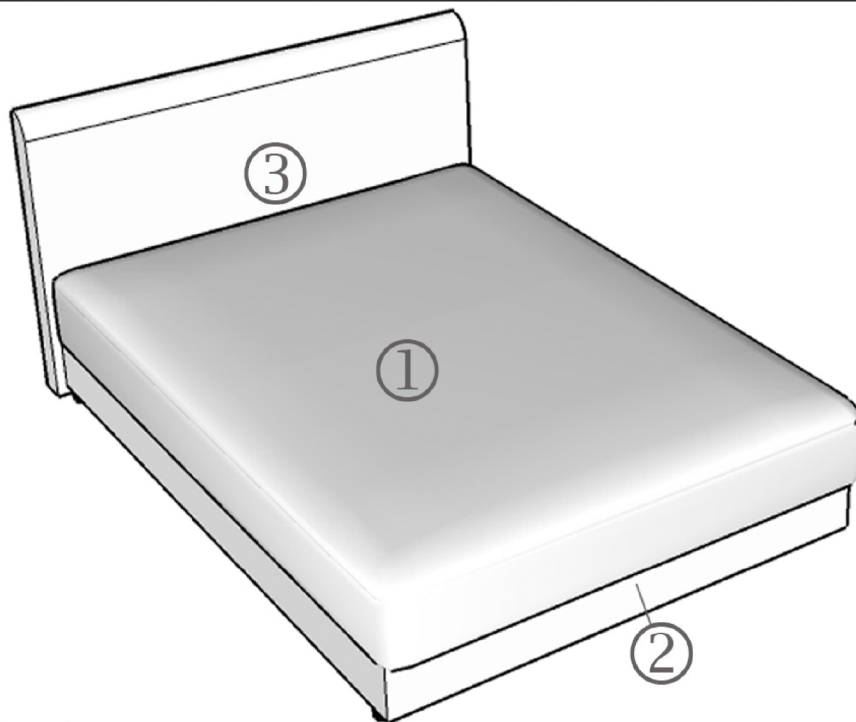

- 1. Mattress
- 2. Bed linen box
- 3. Headboard

Step1.

Put bed linen box 2 with it's floor up. Position four plastic legs in corners where holes are. Use pressure to connect plastic legs with floor.

Position two plastic legs in the middle of the box, where on the other side wooden beams are positioned inside the box. Connect legs with floor.using screws.

When the legs are mounted, turn the box so that it stands on legs.

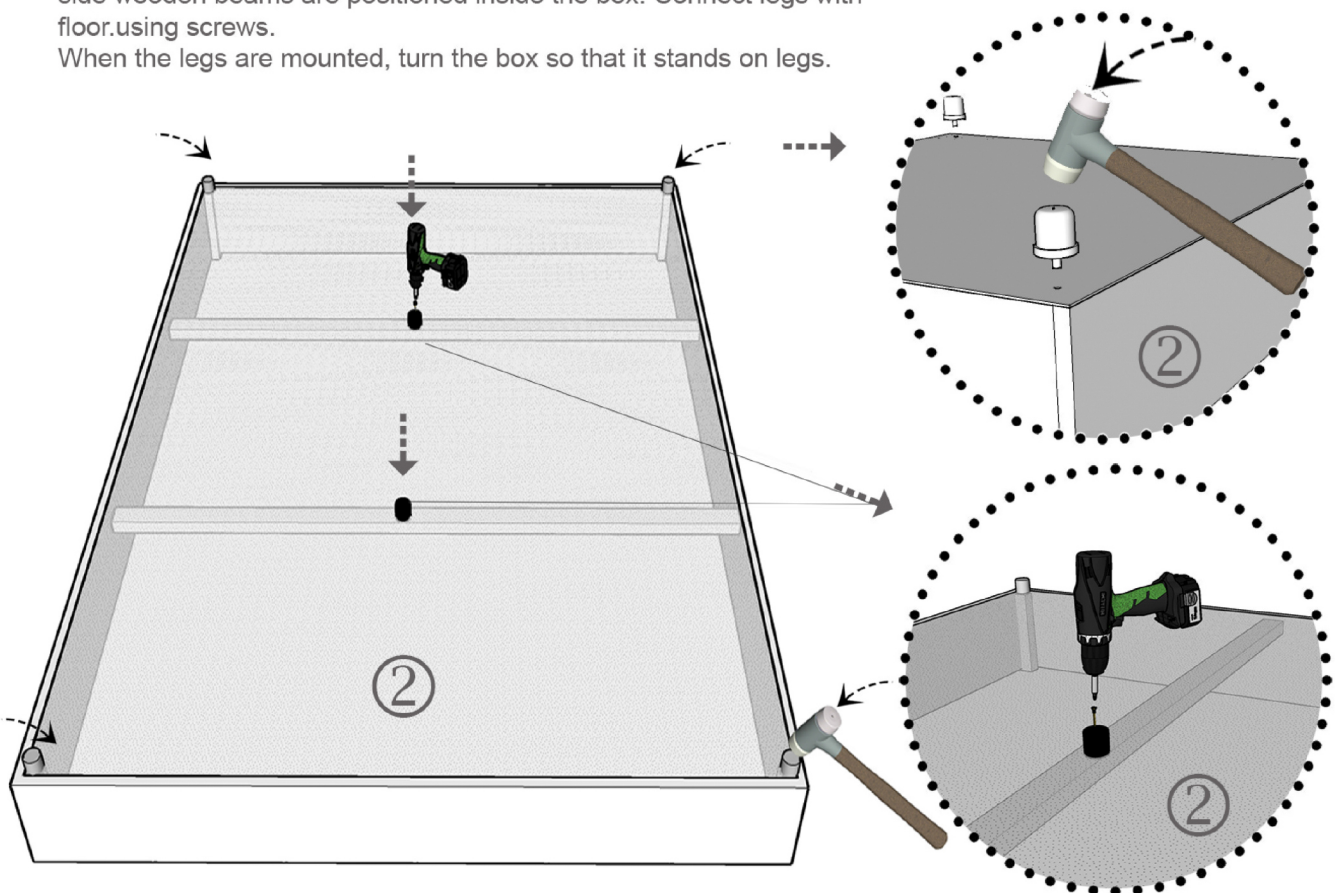

Step 2.

Place the headboard 3 parallel to the shorter side of the bed linen box 2. Place the three carriage bolts that are attached to the headboard 3 in the direction of the holes on the bed linen box 2. Connect headboard 3 to the bed linen box 2 by screwing the carriage bolts with flat washer and hexagonon nuts through holes.inside of the bed linen box 2.

